

EAN: 4015474684447
static.hansa.com/0361203090

Spare parts

SP03612030

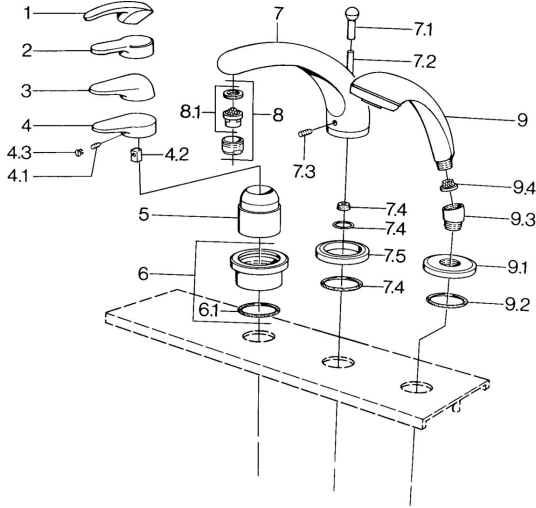

| | Name | Code |
|-----|--|-----------|
| 4.1 | Screw, M5x8, SW2.5 | 59904755 |
| 4.2 | Bushing | 59904778 |
| 4.3 | Plug, hot/cold | 59906705 |
| 6 | Cover plate Chrome Discontinued | 59911191 |
| 6.1 | O-ring, d 55x2.5 Discontinued | 59911225 |
| 7.1 | Diverter knob Chrome Discontinued | 59910109 |
| 7.3 | Screw, M6x16, SW 2.5 | 59910120 |
| 7.4 | Sealing kit | 59910121 |
| 7.5 | Cover flange Edelmessing Discontinued | 59910923 |
| 7.5 | Cover flange Chrome Discontinued | 59910918 |
| 8 | Aerator, M28x1 D Chrome | 59907198 |
| 9 | Hand shower Chrome/Gold Discontinued | 599043390 |
| 9 | Hand shower Chrome Discontinued | 04320100 |
| 9 | Hand shower Chrome/Satin Discontinued | 599043302 |
| 9 | Hand shower Black Discontinued | 59911952 |
| 9 | Hand shower White/Edelmessing Discontinued | 599043303 |
| 9 | Hand shower Chrome/Satin Discontinued | 599043392 |
| 9 | Hand shower Edelmessing Discontinued | 599043305 |
| 9 | Hand shower Chrome/Edelmessing Discontinued | 599043304 |
| 9.1 | Cover flange Chrome | 59910125 |
| 9.2 | O-ring, 54x3 Discontinued | 59901107 |
| 9.3 | Angle connector White Discontinued | 59911202 |
| 9.3 | Angle connector Chrome | 59911197 |
| 9.3 | Angle connector Satin Discontinued | 59911198 |
| 9.4 | Strainer | 59906859 |