

EAN: 4015474598294
static.hansa.com/02210100

Unterputzventil DN 20 (G 3/4)

mit Gewirdeanschluss DN 20

Einbaulängen:
 X

| | | |
|-----|--------|--------|
| von | 10 bis | 45 mm |
| | 45 bis | 80 mm |
| | 80 bis | 115 mm |

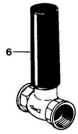
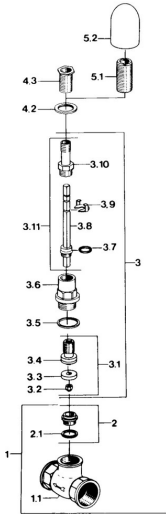

Reserveonderdelen

SP02210100

| | Naam | Code |
|------|----------------------------------------------------|----------|
| 2 | Zetel, DN20 | 59902586 |
| 2.1 | Afdichtring, 24x22x1 Stopgezet | 59902316 |
| 3 | Binnenwerk, 10-45 mm, G3/4 | 59902724 |
| 3 | Binnenwerk, 115-150 mm, G3/4 Stopgezet | 59901454 |
| 3 | Binnenwerk, 45-80 mm, G3/4 | 59902727 |
| 3 | Binnenwerk, 80-115 mm, G3/4 Stopgezet | 59901452 |
| 3.1 | Klep Stopgezet | 59904957 |
| 3.3 | Dichting, G3/4 | 59902754 |
| 3.5 | Dichting, 32x26.5x2 Stopgezet | 59902320 |
| 3.7 | O-ring, d 9.25x1.78 | 59902338 |
| 3.8 | Spindel, 45-80 mm Stopgezet | 59902697 |
| 3.8 | Spindel, 10-45 mm Stopgezet | 59902695 |
| 3.9 | Veerklem | 59901017 |
| 3.10 | Schroefdraad tepel Stopgezet | 59902620 |
| 3.11 | Inbouwverlengstuk compleet, 80-115 mm Chrom | 59905577 |
| 3.11 | Inbouwverlengstuk compleet, L=150 Stopgezet | 59902701 |
| 3.11 | Inbouwverlengstuk compleet, 45-80 mm | 59905576 |
| 4.2 | Kartelmoer | 59902621 |
| 4.3 | Schroefdraad tepel, M12x1/M15x1, AF17 | 59902708 |
| 5.1 | Schroefdraad tepel | 59901373 |
| 5.2 | | 59901106 |