

EAN: 4015474273399
static.hansa.com/65140101

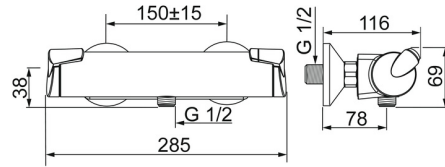

- Shower solutions
- Thermostatic
- Wall mounted
- Chrome
- Temperature control handle, Flow control handle, Easy-Grip surface, Eco feature for water flow, Safety feature for water temperature
- Limitation option for maximum temperature and flow-rate, Safety stop against scalding at 38°C, The housing of the fittings conducts minimal heat, Temperature preset fixable
- Thermostatic cartridge for automatic temperature control, Litter filter(s), Ceramic head part for flow control
- Eccentric coupling(s)
- Inner body made of DZR brass
- protected against back-flow in domestic use (according to DIN EN 1717)

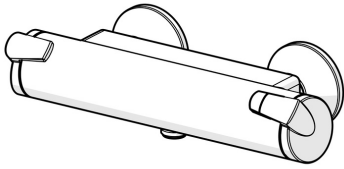

Technical data

Flow properties

Eco-flow at 3 bar	12.6 l/min
Flow-rate at 3 bar	16.2 l/min
Pressure loss with flow (0.2 l/s)	1.6 bar

Technical properties

DN-size (nominal dimension)	DN15
Hot water supply	max. +80°C
Working pressure	1-10 bar
Installation width	150 ± 15 mm
Backflow prevention (EN1717)	EB
Material	Brass/Plastic

Regulations

EN standard	EN 1111
Noise class	I (ISO 3822)

Approvals and Declarations

ABP	PA-IX 38111/IA
Declaration of conformity	DoC

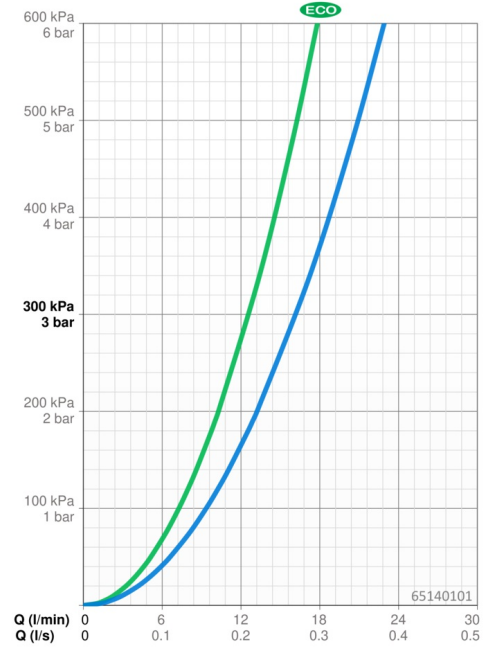

Spare parts

SP65140101

	Name	Code
01	Flow control handle	59914110
02	Headpart, G1/2	59914111
03	Filter sealing, G3/4	59911076
04	Temperature control handle	59914112
05	Thermostatic cartridge, 3,4	59914114

