

EAN: 4057304018480
static.hansa.com/581501710009

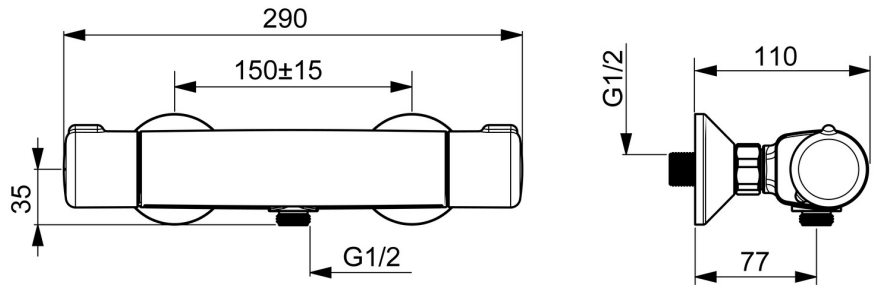

- ECO Building, Housing
- Thermostatic
- Wall mounted
- Chrome
- Eco feature for water flow, Safety feature for water temperature
- Eco flow control
- Safety stop against scalding at 38°C, The housing of the fittings conducts minimal heat
- Ceramic head part for flow control, Thermostatic cartridge for automatic temperature control, Non-return valve(s), Litter filter(s)
- Eccentric coupling(s)
- Inner body made of DZR brass

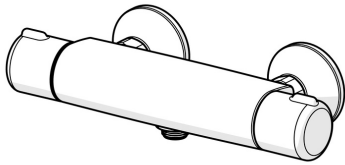

Technical data

Flow properties

Eco-flow at 3 bar	8.5 l/min
Flow-rate at 3 bar (with flow controller)	9.0 l/min

Technical properties

DN-size (nominal dimension)	DN15
Hot water supply	max. +80°C
Working pressure	1-10 bar
Connection size	G3/4
Installation width	150 ± 15 mm
Backflow prevention (EN1717)	EB
Material	Brass

Regulations

EN standard	EN 1111
Noise class	I (ISO 3822) Oras lab.

Approvals and Declarations

ABP	PA-IX 38490/IB
Declaration of conformity	DoC
EPD	S-P-06397

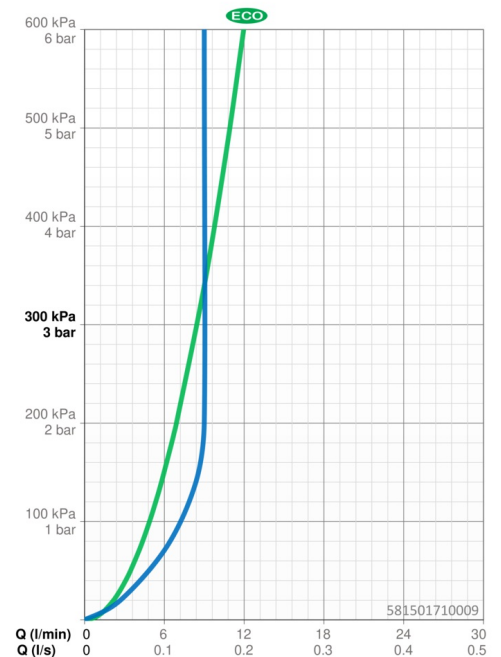

Spare parts

SP58150171

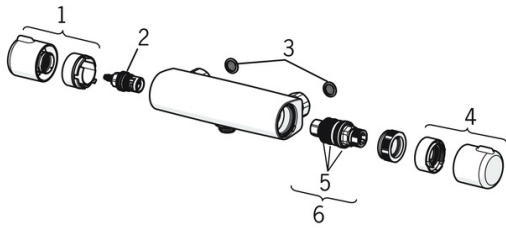

	Name	Code
1	Flow control handle	59914395
2	Headpart, G1/2	59914111
3	Filter sealing, G3/4	59911076
4	Temperature control handle	59914396
5	O-ring kit	59914113
6	Thermostatic cartridge, 3.4	59914114
N.I.	Tightening nut, M36x1.5, SW38	59914319
N.I.	Eccentric, G3/4xG1/2	59904793
N.I.	Combiner	59914472