

EAN: 4057304018466  
[static.hansa.com/581501710006](https://static.hansa.com/581501710006)

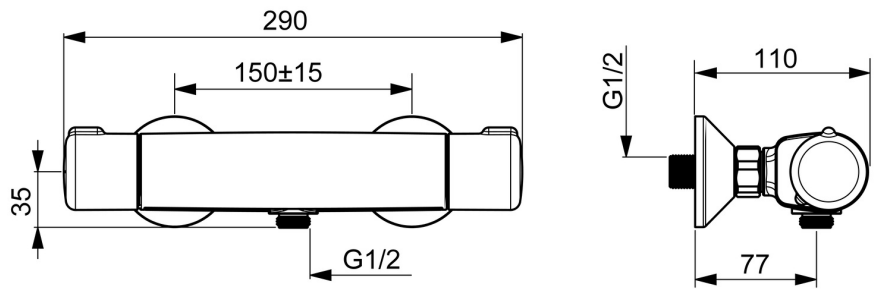

- Public & Semi-public, ECO Building, Housing
- Thermostatic
- Wall mounted
- Chrome
- Eco feature for water flow, Safety feature for water temperature
- Eco flow control
- Safety stop against scalding at 38°C, The housing of the fittings conducts minimal heat
- Ceramic head part for flow control, Thermostatic cartridge for automatic temperature control, Non-return valve(s), Litter filter(s)
- Eccentric coupling(s)

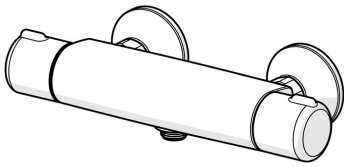

## Technical data

### Flow properties

Eco-flow at 3 bar	<b>5.0 l/min</b>
Flow-rate at 3 bar (with flow controller)	<b>6.0 l/min</b>

### Technical properties

DN-size (nominal dimension)	<b>DN15</b>
Hot water supply	<b>max. +80°C</b>
Working pressure	<b>1-10 bar</b>
Connection size	<b>G3/4</b>
Installation width	<b>150 ± 15 mm</b>
Backflow prevention (EN1717)	<b>EB</b>
Material	<b>Brass</b>

### Regulations

EN standard	<b>EN 1111</b>
Noise class	<b>I (ISO 3822) Oras lab.</b>

### Approvals and Declarations

ABP	<b>PA-IX 38490/IB</b>
Declaration of conformity	<b>DoC</b>
EPD	<b>S-P-06397</b>

### Sustainability

EPD module A1 (kg CO2 eq.)	<b>9,39</b>
EPD module A2 (kg CO2 eq.)	<b>0,44</b>
EPD module A3 (kg CO2 eq.)	<b>1,08</b>
EPD module A1-A3 (kg CO2 eq.)	<b>10,91</b>
EPD module A4 (kg CO2 eq.)	<b>0,39</b>
EPD module B7 (kg CO2 eq.)	<b>875,65</b>
EPD module C2 (kg CO2 eq.)	<b>0,02</b>
EPD module C3 (kg CO2 eq.)	<b>0,02</b>
EPD module C4 (kg CO2 eq.)	<b>0,78</b>
EPD module D (kg CO2 eq.)	<b>-6,92</b>

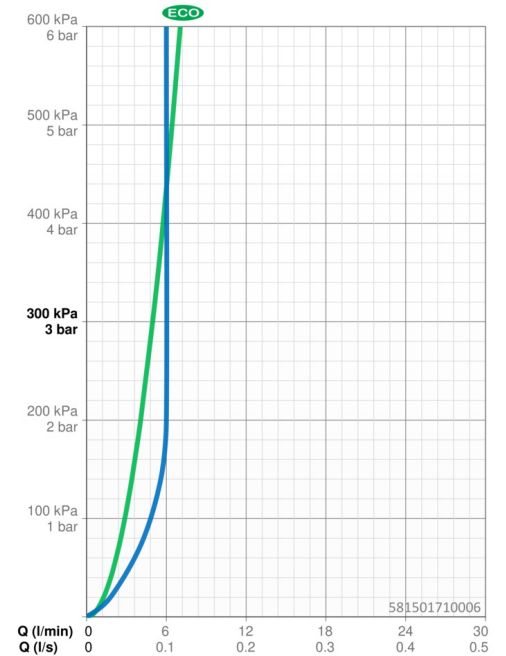

## Spare parts

### SP58150171

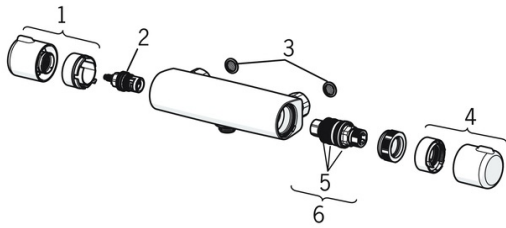

	Name	Code
1	Flow control handle	59914395
2	Headpart, G1/2	59914111
3	Filter sealing, G3/4	59911076
4	Temperature control handle	59914396
5	O-ring kit	59914113
6	Thermostatic cartridge, 3.4	59914114
N.I.	Tightening nut, M36x1.5, SW38	59914319
N.I.	Eccentric, G3/4xG1/2	59904793
N.I.	Combiner	59914472