

EAN: 4057304020582
static.hansa.com/58080301



HANSAPRISMA. A Harmony of Simplicity and Elegance.

The timeless silhouette of an ancient, handcrafted bridge, perfectly mirrored in tranquil waters, evolves into a slender and elegant cylindrical thermostat. Meticulously designed handles seamlessly complete the form without compromising functionality, exuding elegance from every angle.

Crafted to echo the refined elements of nature, this design uplifts any bathroom space. Elegant and functional, it reflects the essence of the HANSAPRISMA

ELEVATING YOUR MOMENTS

- Shower solutions
- Thermostatic
- Wall mounted
- Chrome
- Temperature control handle, Flow control handle, Hot/Cold symbols, Eco feature for water flow
- Safety stop against scalding at 38°C, The housing of the fittings conducts minimal heat
- Ceramic head part for flow control, Thermostatic cartridge for automatic temperature control, Non-return valve(s), Litter filter(s)
- Eccentric coupling(s), Cover plate(s), Silencer(s)
- Inner body made of DZR brass

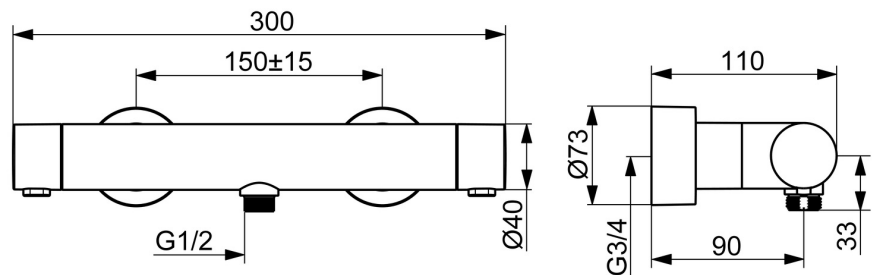
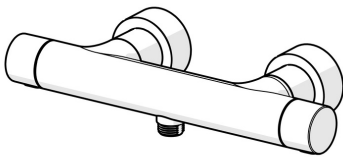

Technical data

Flow properties

Eco-flow at 3 bar	15.0 l/min
Flow-rate at 3 bar	17.4 l/min

Technical properties

Hot water supply	max. +80°C
Working pressure	1-10 bar
Connection size	G3/4
Installation width	150 ± 15 mm
Backflow prevention (EN1717)	EB
Material	Brass/Plastic

Regulations

EN standard	EN 1111
Noise class	I (ISO 3822)

Approvals and Declarations

Declaration of conformity	DoC
---------------------------	------------

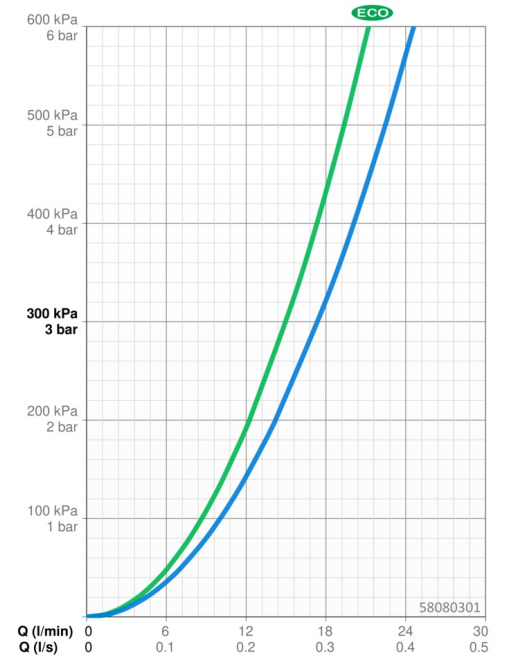

Spare parts

SP58080301

	Name	Code
01	Temperature control handle	1018476V
02	Thermostatic cartridge, 3.4	59914114
03	Headpart, G1/2	59914207
04	Flow control handle	1018478V
05	Non-return valve, DW15/DN10K	1018484V