

EAN: 4015474261273  
[static.hansa.com/52472277](http://static.hansa.com/52472277)

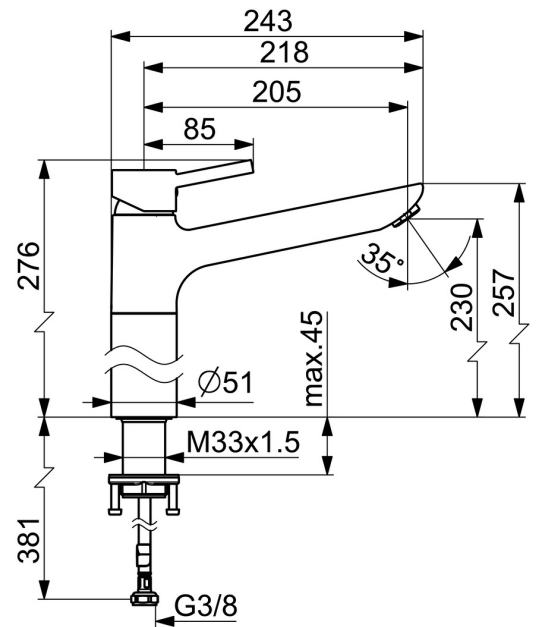

- Washbasin
- Single-lever
- Deck mounted
- Chrome
- Swivel spout
- Standard aerator
- Hot/Cold symbols, Pin shape, Single operating lever/handle
- Limitation option for maximum temperature and flow-rate, Adjustable hot water stop (included, retrofittable)
- $\phi$  35 mm ceramic cartridge for flow and temperature control
- Flexible inlet pipes
- Inner body made of DZR brass
- Without pop-up waste

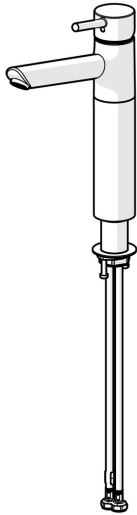

## Technical data

### Flow properties

Flow-rate at 3 bar (with flow controller) **6.0 l/min**

### Technical properties

DN-size (nominal dimension) **DN15**  
 Hot water supply **max. +70°C**  
 Working pressure **0.5-10 bar**  
 Connection size **G3/8**  
 Projection **205 mm**  
 Backflow prevention (EN1717) **AA**  
 Material **Brass**

### Regulations

EN standard **EN 817**  
 Noise class **I (ISO 3822)**

### Approvals and Declarations

Declaration of conformity **DoC**

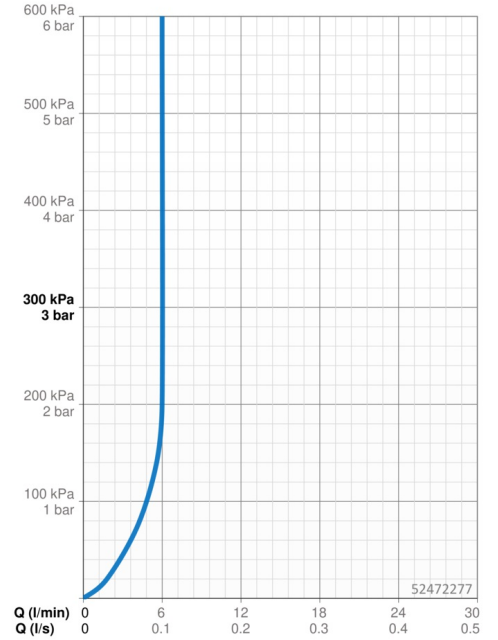

## Spare parts

### SP52472277

	Name	Code
1	Lever	59913903
1.1	Screw, M5x8, SW2.5	59904755
1.3	Symbol plug Grey	59912112
2	Covering cap, 33x3 mm	59912504
3	Tightening nut, M37x1, AF30 Discontinued	59912111
4	Cartridge, 3.5 Classic	59913075
4.1	Temperature adjustment limiter	59912325
4.3	O-ring, d 28.24x2.62 Discontinued	59912590
4.4	O-ring, d 10.10x1.60 Discontinued	59905072
5.1	Fixing set	59913371
5.2	Flexible pipe, L=550, G3/8-M8x1	59913969
5.3	Gasket, 9.5x14.4x2	59912551
6	Aerator, M24x1, 6 l/min	59913727
N.I.	Key, SW30/34	59912108

### SP52472277(2020)

	Name	Code
01	Lever	59913903
02	Covering cap, 33x3 mm	59912504
03	Tightening nut, M37x1, SW30	1005680V
04	Cartridge, 3.5 Classic	59913075
05	Aerator, M24x1, 6 l/min	59913727
06	Sealing kit	1001264V
07	Spout overturning stopper, 120°	59914489
08	Bottom seal	59914650
09	Fixing set	59913371

