

EAN: 4015474238657  
[static.hansa.com/46120103](https://static.hansa.com/46120103)

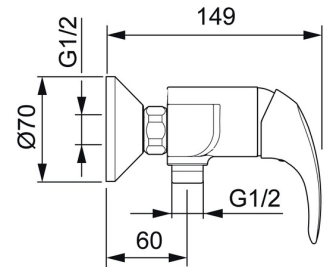

- Shower solutions
  - Single-lever
  - Wall mounted
  - Chrome
  - Hot/Cold symbols, Single operating lever/handle
- Limitation option for maximum temperature and flow-rate, Adjustable hot water stop (included, retrofittable)
  - Non-return valve(s),  $\varnothing$  35 mm ceramic cartridge for flow and temperature control
  - Eccentric coupling(s)
  - Inner body made of DZR brass
  - protected against back-flow in domestic use (according to DIN EN 1717)

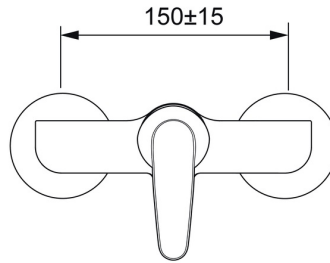
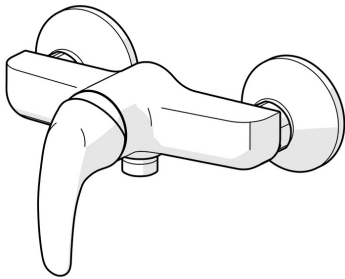

## Technical data

### Flow properties

Flow-rate at 3 bar	<b>16.8 l/min</b>
Pressure loss with flow (0.2 l/s)	<b>1.6 bar</b>

### Technical properties

DN-size (nominal dimension)	<b>DN15</b>
Hot water supply	<b>max. +90°C</b>
Working pressure	<b>0.5-10 bar</b>
Connection size	<b>G3/4</b>
Installation width	<b>150 ± 15 mm</b>
Backflow prevention (EN1717)	<b>EB</b>
Material	<b>Brass</b>

### Regulations

EN standard	<b>EN 817</b>
Noise class	<b>PA-IX 19662/IB</b>

### Approvals and Declarations

KIWA	<b>K6116/08</b>
Declaration of conformity	<b>DoC</b>

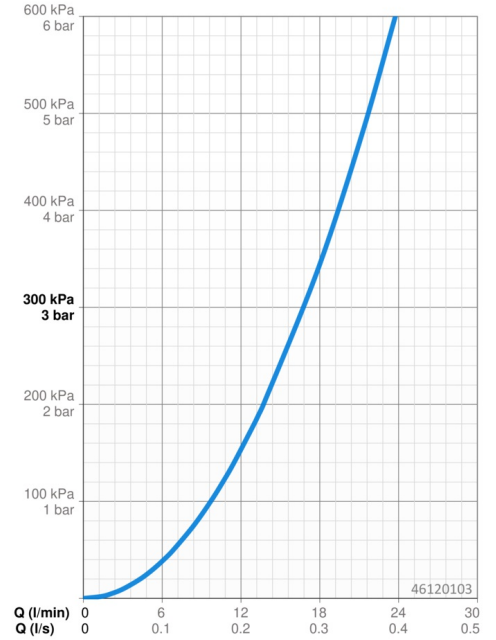

## Spare parts

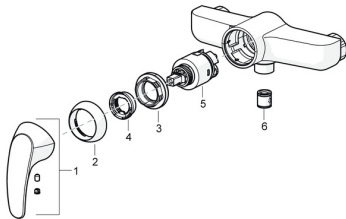

### SP46120103

	Name	Code
1	Lever	59913678
2	Covering cap, 33x3 mm	59912504
3	Tightening nut, M40x1	1003409V
4	Temperature adjustment limiter	59912325
5	Cartridge, 3.5 Classic	59913075
6	Non-return valve	59905714
N.I.	Connection nut, G3/4, AF30	59902230
N.I.	Retaining ring, 23.9x15.2x2	59902689
N.I.	Screw, M5x8, SW2.5	59904755
N.I.	Eccentric, G3/4xG1/2	59904793
N.I.	Cover flange	59904796
N.I.	Key, SW30/34	59912108
N.I.	Symbol plug Grey	59912112
N.I.	Connector	59913400