

EAN: 4057304010958  
[static.hansa.com/44350100](https://static.hansa.com/44350100)

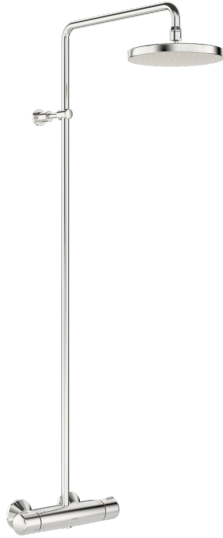

- Shower solutions
- Thermostatic
- Wall mounted
- Chrome
- Temperature control handle, Flow control handle
- Shower rail, Overhead shower, Variable fixing points, Rotatable ball joint connection, Anti limescale technology (easy to clean)
- Rain - Even and strong water stream
- Safety stop against scalding at 38°C, The housing of the fittings conducts minimal heat
- Ceramic head part for flow control, Thermostatic cartridge for automatic temperature control, Non-return valve(s), Litter filter(s)
- Eccentric coupling(s), External thread, Cover plate(s), Silencer(s)
- Flexible length / can be shortened

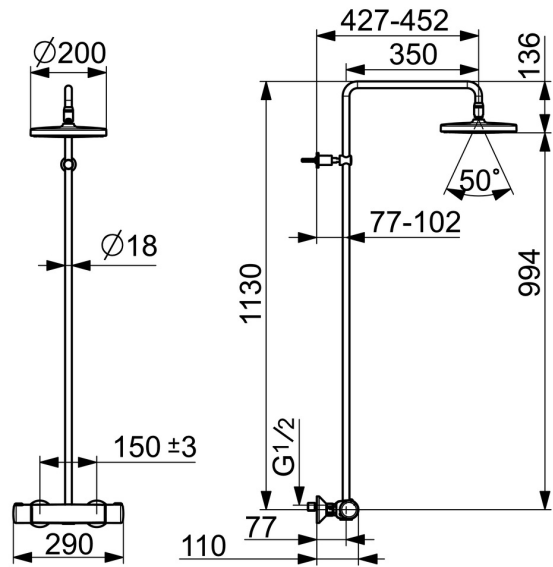
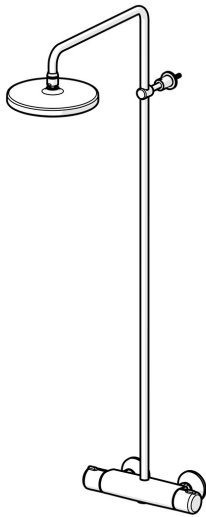

## Technical data

### Flow properties

Flow-rate at 3 bar	<b>16.2 l/min</b>
Pressure loss with flow (0.2 l/s)	<b>1.7 bar</b>

### Technical properties

DN-size (nominal dimension)	<b>DN15</b>
Hot water supply	<b>max. +65°C</b>
Working pressure	<b>1-10 bar</b>
Connection size	<b>G1/2</b>
Installation width	<b>150 ± 15 mm</b>
Projection	<b>427 - 452 mm</b>
Backflow prevention (EN1717)	<b>EB</b>
Material	<b>Brass</b>

### Regulations

EN standard	<b>EN 1111</b>
Noise class	<b>I (ISO 3822)</b>

### Approvals and Declarations

ABP	<b>P-IX 29854/IS</b>
ACS	<b>20 ACC LY 145</b>
Declaration of conformity	<b>DoC</b>

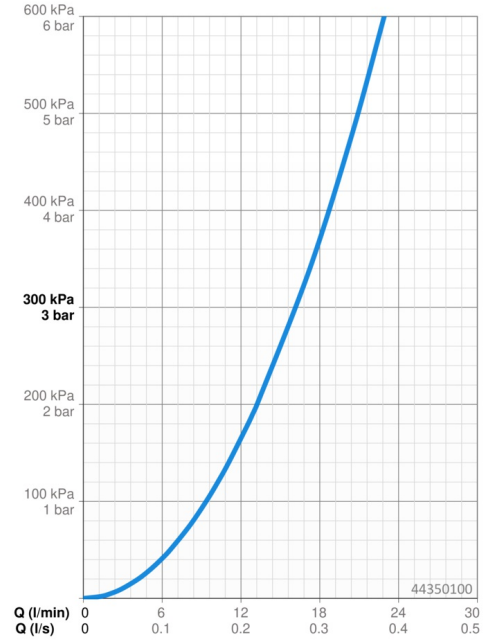

## Spare parts

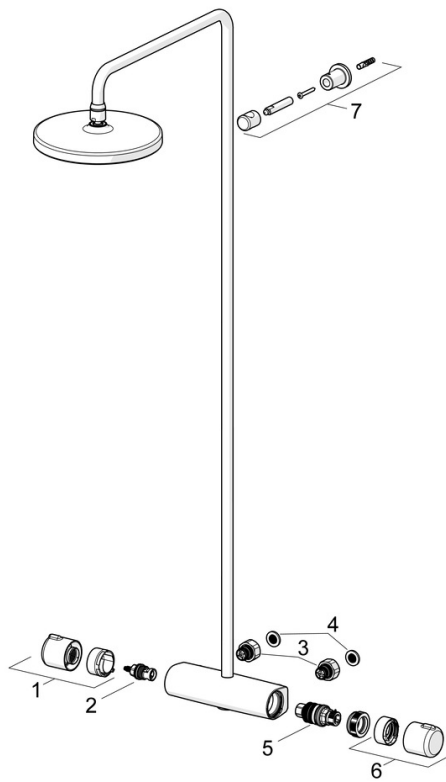

### SP44350100

	Name	Code
01	Flow control handle	59914395
02	Headpart, G1/2	59914207
03	Combiner	59914472
04	Filter sealing, G3/4	59911076
05	Thermostatic cartridge, 3.4	59914114
06	Temperature control handle	59914396
07	Shower pipe holder	59914773