

EAN: 4057304014048  
[static.hansa.com/09479279](https://static.hansa.com/09479279)

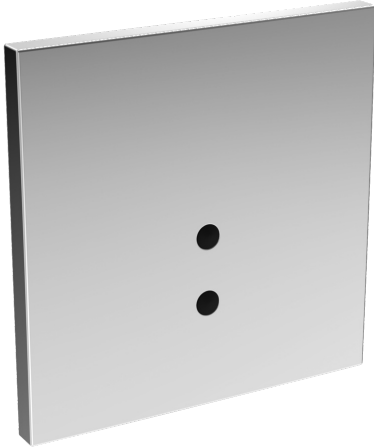

- Public & Semi-public, Industry
- Trim Kit, Touchless, Bluetooth®, Battery-operated
- Concealed wall mounting
- Chrome
- Autofocus infrared sensor, Solenoid valve, Low battery indicator
- Software settings adjustable via App
- Square rosette

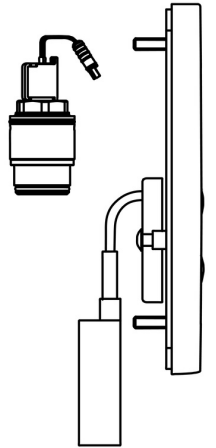
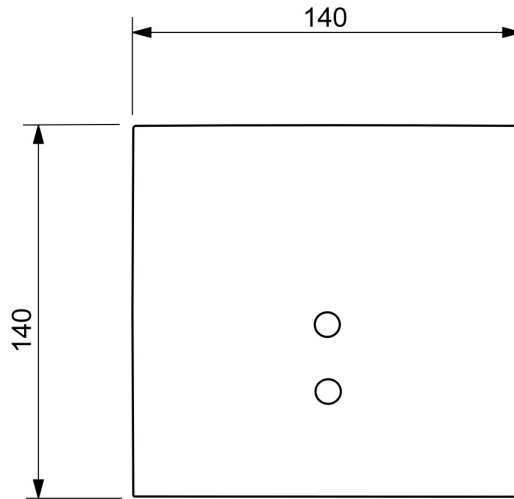
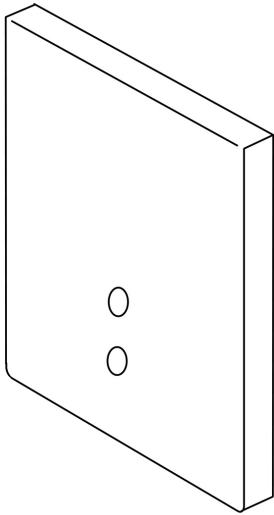

## Technical data

### Flow properties

Flow-rate at 3 bar **12.0 l/min**

### Technical properties

Hot water supply **max. +70°C**  
Working pressure **0.5-10 bar**

### Software settings

Automatic flush **24 h (off/1-120 h)**  
Automatic flush period **6 s (1-120 s)**  
Pre-flush period **2 s (OFF / 1-10 s)**

### Electronic properties

Battery **Lithium 2CR5 6 V**  
Bluetooth version **4.x (D034445)**

### Regulations

EU Directives **C € Radio Equipment Directive 2014/53/EU , Low Voltage Directive 2014/35/EU , EMC Directive 2014/30/EU , RoHS Directive 2011/65/EU**  
EN standard **EN 15091, ETSI EN 301 489-1 V1.9.2 , ETSI EN 300 328 v2.2.2 , EN 61000-6-1:2007 , EN 61000-6-3:2007+A1:2011+AC:2012 , EN 60335-1:2012+A11+A13+A1+A14+A2+A15:2021, Part 19.11.4**  
Protection class **IP 55**

### Approvals and Declarations

UN38.3 **UN38-3 Maxell 2CR5**  
Declaration of conformity **RED**

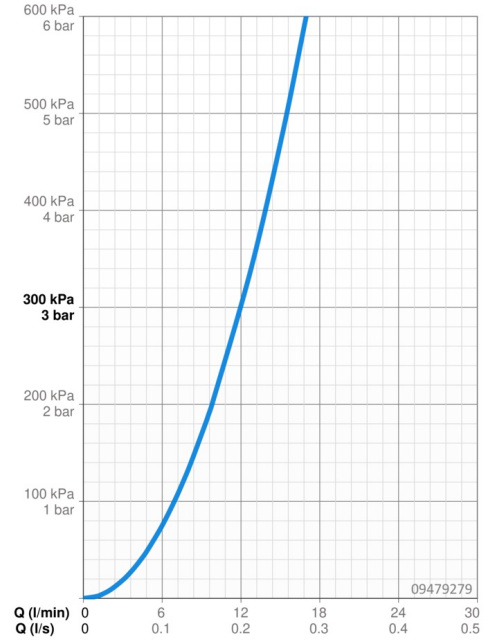

## Spare parts

---

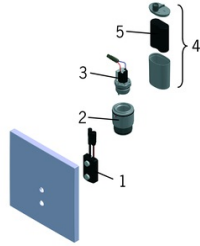

### SP09479272

---

	<b>Name</b>	<b>Code</b>
1	Sensor, 6/9/12 V Bluetooth	1002253V
1	Sensor, 6 V, (-2020)	59914233
2	Membrane housing	59914231
3	Pilot valve, 6 V	59914232
4	Battery casing	59914154
5	Battery, 2CR5 6 V	59911670