

EAN: 4015474598294  
[static.hansa.com/02210100](https://static.hansa.com/02210100)

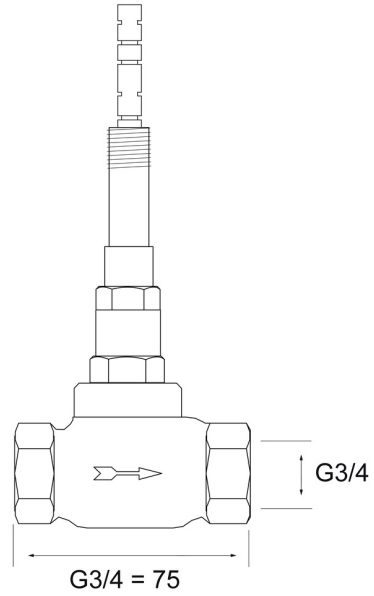

- Accessories
- Concealed wall mounting
- Non-ceramic head part for flow control
- Inner body made of DZR brass

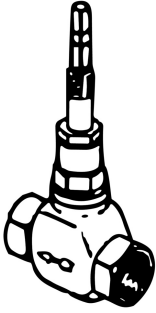

## Technical data

### Flow properties

Flow-rate at 3 bar **48.0 l/min**

### Technical properties

DN-size (nominal dimension) **DN20**  
 Hot water supply **max. +80°C**  
 Working pressure **1-10 bar**  
 Connection size **G3/4**

### Regulations

EN standard **EN 200**

### Approvals and Declarations

Declaration of conformity **DoC**

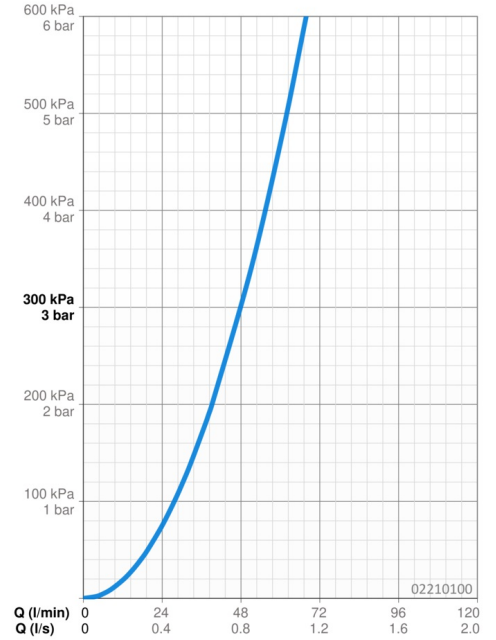

## Spare parts

### Unterputzventil DN 20 (G 3/4)

mit Gewindeanschluß DN 20:

Einbautiefen:

X **von 10 bis 45 mm**  
**45 bis 80 mm**  
**80 bis 115 mm**

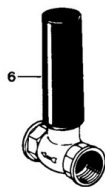
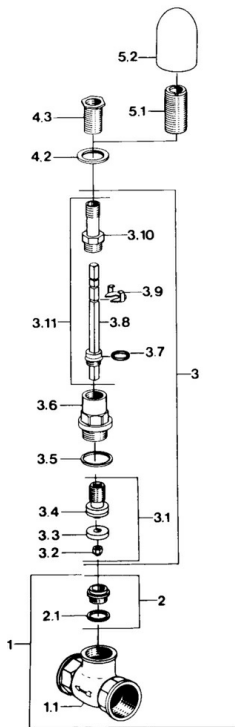

### SP02210100

	Name	Code
2	Seat, DN20	59902586
2.1	Gasket ring, 24x22x1 Discontinued	59902316
3	Headpart, 10-45 mm, G3/4	59902724
3	Headpart, 115-150 mm, G3/4 Discontinued	59901454
3	Headpart, 45-80 mm, G3/4	59902727
3	Headpart, 80-115 mm, G3/4 Discontinued	59901452
3.1	Valve Discontinued	59904957
3.3	Gasket, G3/4	59902754
3.5	Gasket, 32x26.5x2 Discontinued	59902320
3.7	O-ring, d 9.25x1.78	59902338
3.8	Spindle, 45-80 mm Discontinued	59902697
3.8	Spindle, 10-45 mm Discontinued	59902695
3.9	Spring clip	59901017
3.10	Thread nipple Discontinued	59902620
3.11	Raising kit, 80-115 mm	59905577
3.11	Raising kit, L=150 Discontinued	59902701
3.11	Raising kit, 45-80 mm	59905576
4.2	Knurled nut	59902621
4.3	Thread nipple, M12x1/M15x1, AF17	59902708
5.1	Thread nipple	59901373
5.2	Shut-off cap	59901106