

EAN: 4015474661721
static.hansa.com/01782112

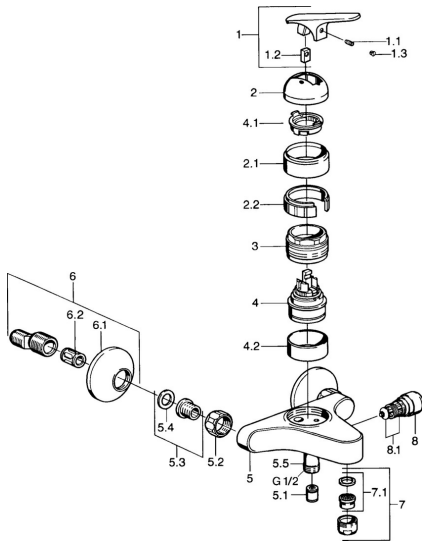

- Bath tub & Shower
- Single-lever
- Wall mounted
- Chrome
- Non-return valve(s)
- Silencer(s)

Technical data

Technical properties

| | |
|------------------------------|-------------------|
| Hot water supply | max. +80°C |
| Working pressure | 0.5-10 bar |
| Backflow prevention (EN1717) | EB |

Spare parts

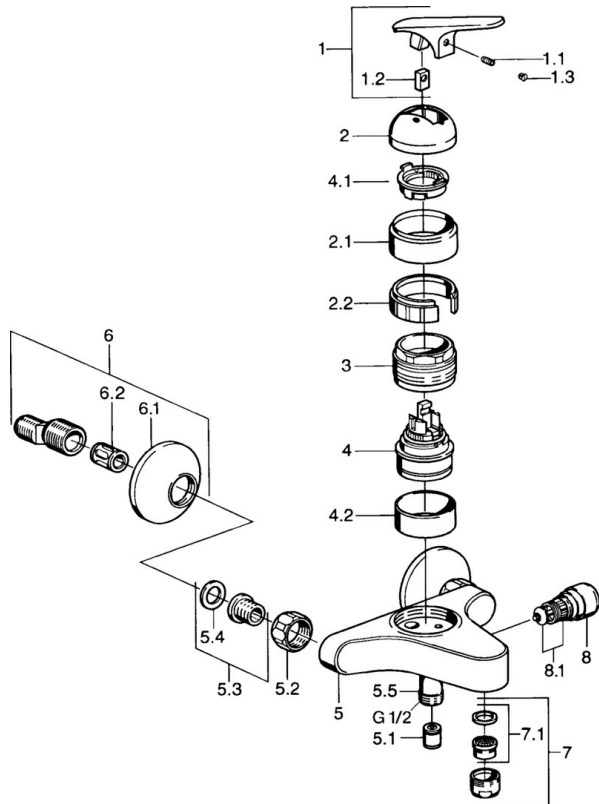

SP01782102

| Name | Code |
|---------------------------------|----------|
| 1.1 Screw, M5x8, SW2.5 | 59904755 |
| 1.2 Bushing | 59904778 |
| 1.3 Plug, hot/cold | 59906705 |
| 2 Covering cap Discontinued | 59905867 |
| 2.1 Cover Discontinued | 59911420 |
| 2.2 Holder Discontinued | 59911421 |
| 3 Tightening nut, M52x1, AF45 | 59911161 |
| 4 Cartridge, 4.8 eco | 59904601 |
| 4.1 Hot water limiter | 59904759 |
| 4.2 Spacer sleeve Discontinued | 59905871 |
| 5.1 Non-return valve | 59905714 |
| 5.2 Connection nut, G3/4, AF30 | 59902230 |
| 5.3 Seat, G1/2, L, WAF10 | 59904618 |
| 5.4 Retaining ring, 23.9x15.2x2 | 59902689 |
| 5.5 Connector | 59906277 |
| 6 Eccentric, G3/4xG1/2 | 59904793 |
| 6.1 Cover flange | 59904796 |
| 6.2 Silencer | 59904792 |
| 7 Aerator, M24x1 B | 59905872 |
| 7.1 Aerator, M22/M24 | 59905873 |
| 8 Diverter | 59910803 |
| 8.1 Sealing kit | 59904791 |